



## What is “Japanese Live College” ?

- This is a way of future education and learning!!
- This is a Cyber-school which delivers you live lessons and live seminars on the internet!  
There are many things you don’ t know until you experience “live-communication” !
- “Japanese Live College” is completely different from existing e-Learning programs. We guarantee you will find out the differences and enjoy lessons and seminars!!



# Steps to take a lesson

STEP 1



## Choose a class and purchase it.

You can choose a class which you like to participate and purchase it. We provide many payment methods.

STEP 2



## Login to a "My Page" .

Please access to the "My Page" from the top page of Japanese Live College and login with your ID and password.

STEP 3



## Enter the classroom.

You can enter the classroom from a list of the lessons and the seminars on the "My Page" . The classroom is open 30 minutes before the lessons and seminars start.

# How do you study at "Japanese Live College" ?



Any software is unnecessary to be installed when taking lessons. The class style you are familiar with, when you were a student, is on the internet. You can raise your hands when asking questions to your teacher, and you can talk to your friends. "Japanese Live College" provides you a true classroom in the office and home, wherever you are!!

# Useful functions of “Japanese Live College”

 **Emotion map** This is to show others your emotion or how much you understand.

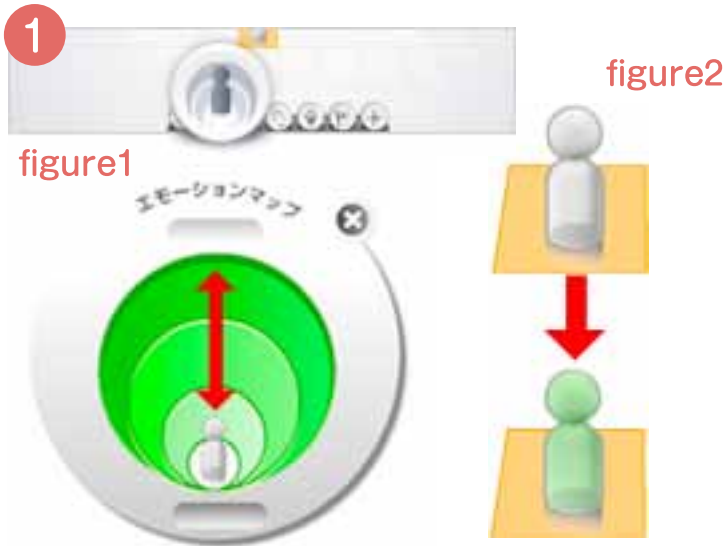

An emotion map (figure 1) appears by clicking on an “Emotion Map” icon (①). The emotion map expresses your feeling from “difficult” to “easy” in four levels divided by colors. The teacher can see the level of understanding and difficulty of each student by the colors. Your icon color changes when moving a human-shape-icon in the emotion map (figure 2). The emotion map can be closed by clicking on “X” on the right top.

 **Question box** This is to ask questions to your teacher with text.



Question box appears by clicking on a “Question Box” . You can type and post questions to the teacher. Clicking “+” enlarges the question box, and clicking “X” makes it invisible. Although you set the question box as invisible, the message remains in the box so you can take lessons with a preferable lay-out. The box can be visible by clicking the “Question Box” (①) when it’s invisible.

 **Raising hand** This is to answer to the teacher’s questions.

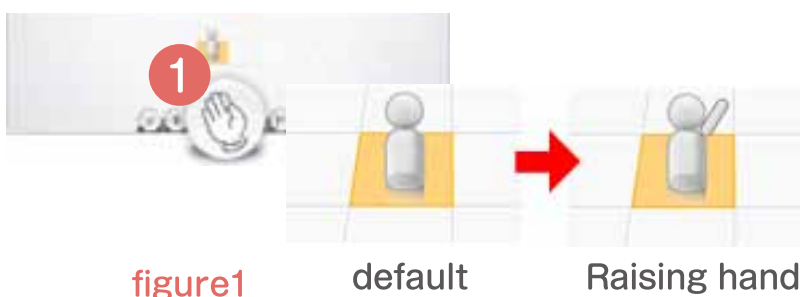

You can communicate with the teacher by raising your hand when the teacher asks the students “Please raise your hand if you don’t understand this” . Your icon raises hand by clicking an “Raising Hand” icon (①), and by clicking the icon again makes its hand put down.

 **Microphone** This is to communicate with the teacher by voice.



When the teacher accepts you to speak, you can actually speak to the teacher. An audio panel is open (figure 1) after getting accepted.  
Your voice is delivered to the teacher when you speak to the microphone. The sound level is changed depending on the volume of your voice. The volume should be within the red frame (figure 2).

\*A microphone is necessary for using this function.

 **Resume** This is to enlarge the textbook.



A textbook is displayed in a red frame (figure 1). You can turn pages and choose a page from a menu by pointing the textbook with a cursor.

The display can be enlarged by clicking a "Textbook" icon (①) so that the textbook can be easier to read.

The lay-out is back to the normal size by clicking a "Return" button on the right down.  
\*Priority is given to the teacher when turning pages. The students' page is automatically changed by the teacher's operation.

 **Cross-area messages** This is to exchange messages with your friends.



You can exchange short messages with your friends seen around your icon. A message box (figure 1) is displayed when you click your friend's icon to chat. Your message is displayed after sending the message (figure 2). The message box is closed by clicking the "Cross-area Message" or "X" on the right top.

# Review

The lesson is recorded when it finishes. The video is convenient when you would like to review the lesson, or when you missed the lesson. It is available from the “My Page” .



## How to browse a study room



(1) Please click a “Past Class (Study Room)” from a “Class Information” of the “My Page”

(2) A list of the past classes is displayed. The video is ready by clicking a blue “Review” button.

(3) The video starts by clicking a “Play” button.

東京・秋葉原にある日本語学校・日本語教師養成講座インターカルト日本語学校

# INTERCULTURAL INSTITUTE OF JAPAN

## インターカルト日本語学校・日本語教員養成研究所

(財) 日本語教育振興協会認定校 / 法務省東京入国管理局取次申請指定校  
(社) 日本語教育学会賛助会員校 / 文部科学省認可日本語学校協同組合加盟校

TEL **0120-205-331**  
Weekdays 09 : 00 ~ 17 : 00

email : [livecollege@incul.com](mailto:livecollege@incul.com)